

# MINED LAND

A story of environmental devastation and successful habitat restoration, the Mined Land Wildlife Area (MLWA) is located in Crawford, Cherokee, and Labette counties in southeast Kansas. Mining in the area began

in the late 1800s. Big Brutus, a twelve million pound electric coal shovel, remains near MLWA #44 as a reminder. Today, the area is characterized by woodlands, healthy grasslands, and abundant water.

The first land donation was

received in 1926. The largest acquisition, totalling 8,208 acres, was donated by the Pittsburg and Midway Coal Company to the Kansas Department of Wildlife and Parks in 1981. The area includes 46 tracts totalling 14,500 acres.

## FISHING

Several hundred water-filled pits dot the MLWA, creating about 1,500 acres of public waters. More than 200 lakes on the area are managed for fishing.

Strip-mine lakes produce some of Kansas' finest fishing. Sportfish include largemouth bass, rainbow trout, walleye, channel catfish, crappie, bluegill, redear sunfish, spotted bass, wipers, bullhead, and warmouth. Some lakes have been specially managed to favor certain fish species.

Special length and creel limits may be in effect for some fish species. Check the Kansas Fishing Regulations Summary and all posted notices before fishing. A large lake located within unit 30 is stocked with rainbow trout during late fall through early

spring. Unique characteristics of the lake allow trout to survive year-round. A trout stamp is required by anyone fishing for trout on the MLWA.

Periodically, selected waters are closed to fishing for two years. This allows fish populations to become well established before angling resumes, and creates quality fishing spots.

Most MLWA waters are quite clear, and fishing is challenging. Anglers who approach the water quietly, use light line and fish during low-light hours are more successful. Boats help reach many of the prime fishing spots. The lakes are mostly sheltered from wind and too small for large craft. Small boats and float tubes work best.

Several marshes have been constructed to attract ducks. A waterfowl refuge often holds several hundred Canada geese in the area. The MLWA is located within the southeast dark goose unit (*see the Kansas Waterfowl Regulations Summary*).

The woodlands areas of the property hold excellent populations of white-tailed deer and eastern turkey.

The area supports good numbers of raccoons, muskrats, bobcats, beavers, and coyotes. Other furbearers, including mink, and fox are also common.

trapping are allowed.

Canoeing is allowed on all MLWA waters, while motorized boats may only be used for fishing. No water skiing or personal watercraft use is allowed. Nature trails are located in MLWA 6 and 21.

## THINGS TO REMEMBER

Vehicles are restricted to maintained roads and parking areas. Some roads are closed to all traffic. Do not leave vehicles parked on boat ramps. Use caution when launching boats because ramps drop off sharply, and trailers backed too far may become high-centered. Boat ramps are available on most large lakes.

Swimming is NOT allowed on the area.

Many of the lakes are steep sided, Anglers wading the shorelines should use caution.

Tent camping is allowed at any location except refuge areas. RVs may be parked in designated areas or parking lots. RVs may not block boat ramps, restrict road traffic, or drive off roads. No hookups are available.

Visitors must take their trash with them. Check the Kansas Fishing Regulations Summary and all posted notices before fishing.

Certain areas may be closed to hunting and fishing periodically.

The waterfowl refuge is closed to all hunting. All of area 21 is closed to waterfowl hunting.

Target shooting, trotlines and setlines are prohibited on all areas.

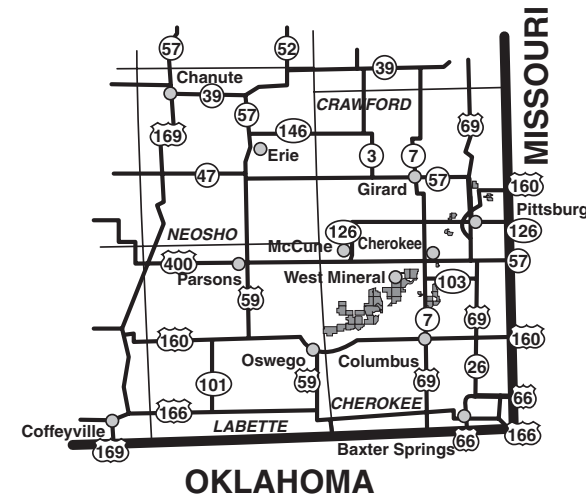

General Area Map

Equal opportunity to participate in and benefit from programs described herein is available to all individuals without regard to race, color, national origin, sex, religion, age or handicap. Complaints of discrimination should be sent to Office of the Secretary, Kansas Department of Wildlife and Parks, 1020 S Kansas Ave. Suite 200, Topeka, KS 66612-1327 04/08

# Mined Land Wildlife Area

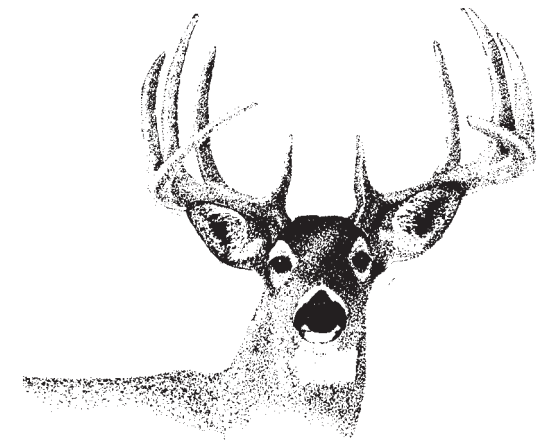

Mined Land Wildlife Area  
507 E. 560th Ave.  
Pittsburg, KS 66762  
(620) 231-3173 (Area Office)  
(620) 827-6301 (Field Office)  
(620) 431-0380 (Regional Office)

Department Website:  
[www.kdwp.state.ks.us](http://www.kdwp.state.ks.us)



# MINED LAND WILDLIFE AREA (WEST MINERAL UNITS)

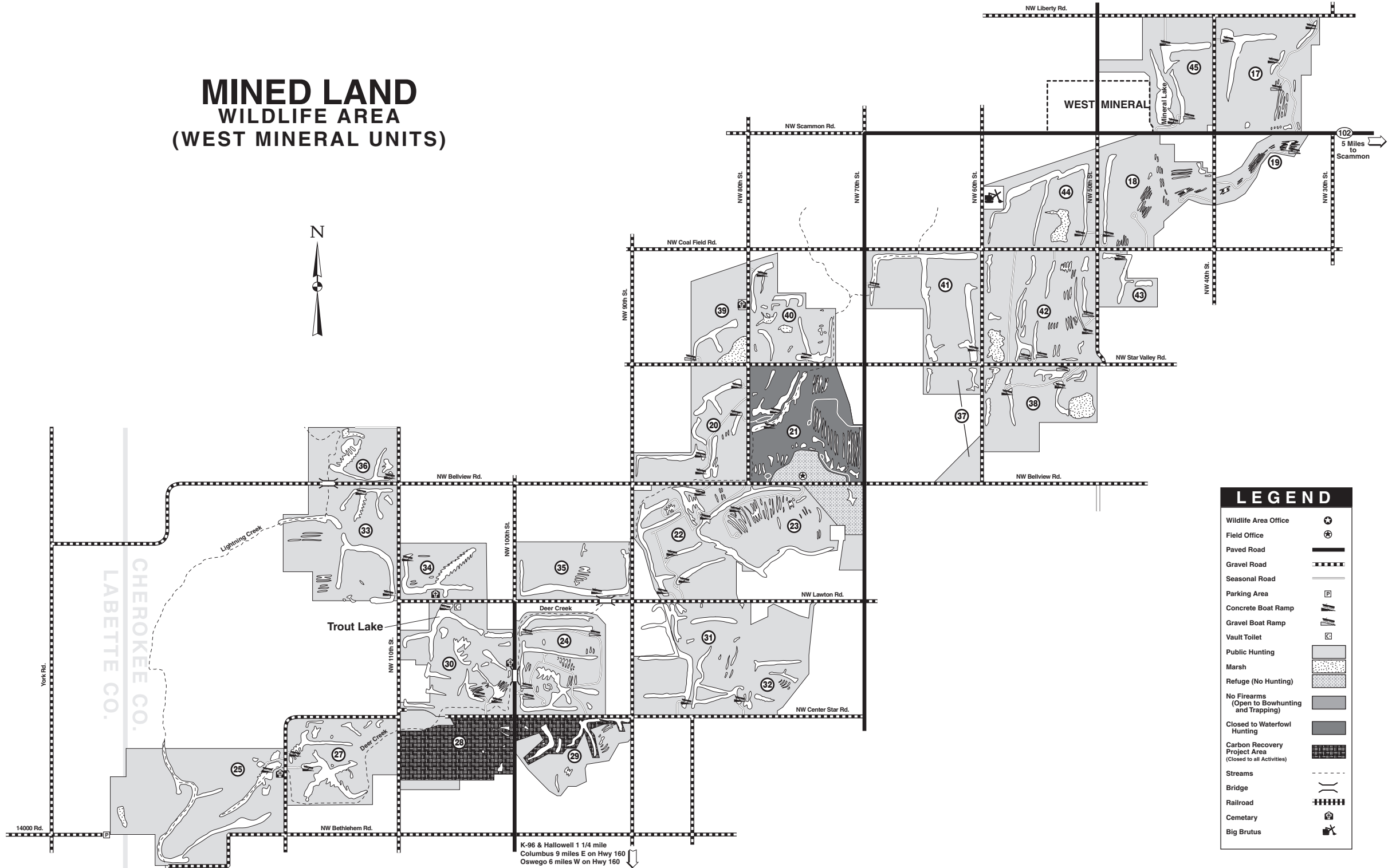

LEGEND	
Wildlife Area Office	
Field Office	
Paved Road	
Gravel Road	
Seasonal Road	
Parking Area	
Concrete Boat Ramp	
Gravel Boat Ramp	
Vault Toilet	
Public Hunting	
Marsh	
Refuge (No Hunting)	
No Firearms (Open to Bowhunting and Trapping)	
Closed to Waterfowl Hunting	
Carbon Recovery Project Area (Closed to all Activities)	
Streams	
Bridge	
Railroad	
Cemetery	
Big Brutus	

K-96 & Hallowell 1 1/4 mile  
Columbus 9 miles E on Hwy 160  
Oswego 6 miles W on Hwy 160